



Installation Instructions

LF-ACCEL

Electronic Left Foot ACCEerator

24/10/2008

Table of contents

<i>Presentation of LF-ACCEL</i>	4
<i>Installation of LF-ACCEL</i>	
<i>Wiring of LF-ACCEL</i>	5
<i>LF-ACCEL wiring tension resistance</i>	9
<i>LF-ACCEL quick diagnosis</i>	10
<i>Left foot pedal installation</i>	11
<i>List of spare parts</i>	12
<i>Technical specifications</i>	14



Presentation of **LF-ACCEL**

LF-ACCEL is an electronic accelerator, which allows an automatic vehicle to be driven with the left foot.

Compatibility

This equipment can be fitted to any vehicle with automatic gearbox* and electronic accelerator pedal.

* Please, contact us for any special vehicle.

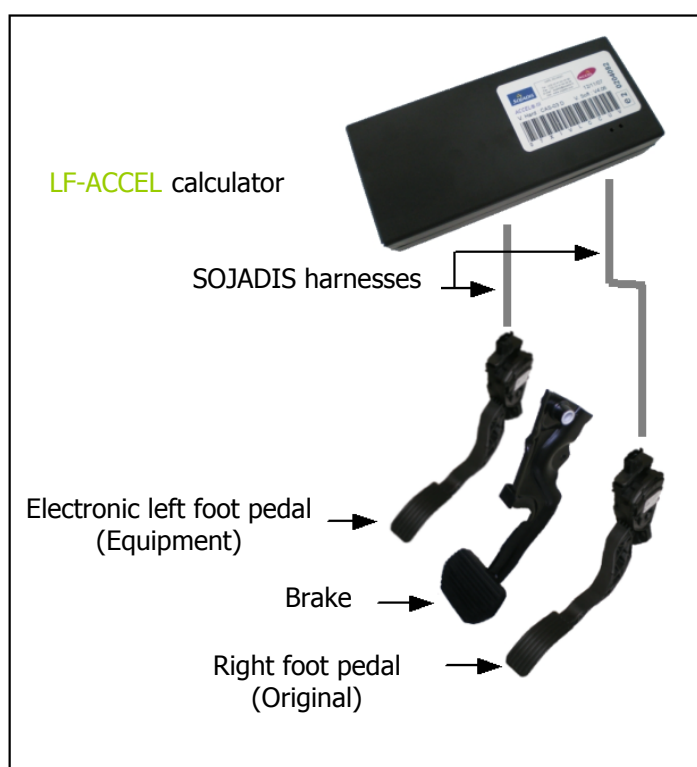

Installation of LF-ACCEL

Wiring of LF-ACCEL

See Wiring diagram next page

Notes:

- ***:** **Make the connection on both sides of Stop contact normally open.**
- ****:** **Some vehicles are equipped with 2 Stop LED lights, slightly illuminated when in LOW BEAM. In this case, please contact *SOJADIS* or your supplier/dealer.**
- *****:** **Way 1 (White wire on Calculator side and Grey wire on pedal side) and Way 2 (Blue wire on Calculator side and Violet wire on pedal side) are analogical ways, parametrizable from 0 to 5 V.
If the vehicle's signals are not analogical or linear and/or if they are not included in this line, please contact *SOJADIS* or your supplier.**
- ******:** ***LF-ACCEL* integrates one parametrizable contact (Pink and Green wires) as *Contact Repos* (closes up at acceleration) or Contact Kick Down (closes up at the end of acceleration).
The second one disables the speed-limiting device (see *Utilisation examples below*).**

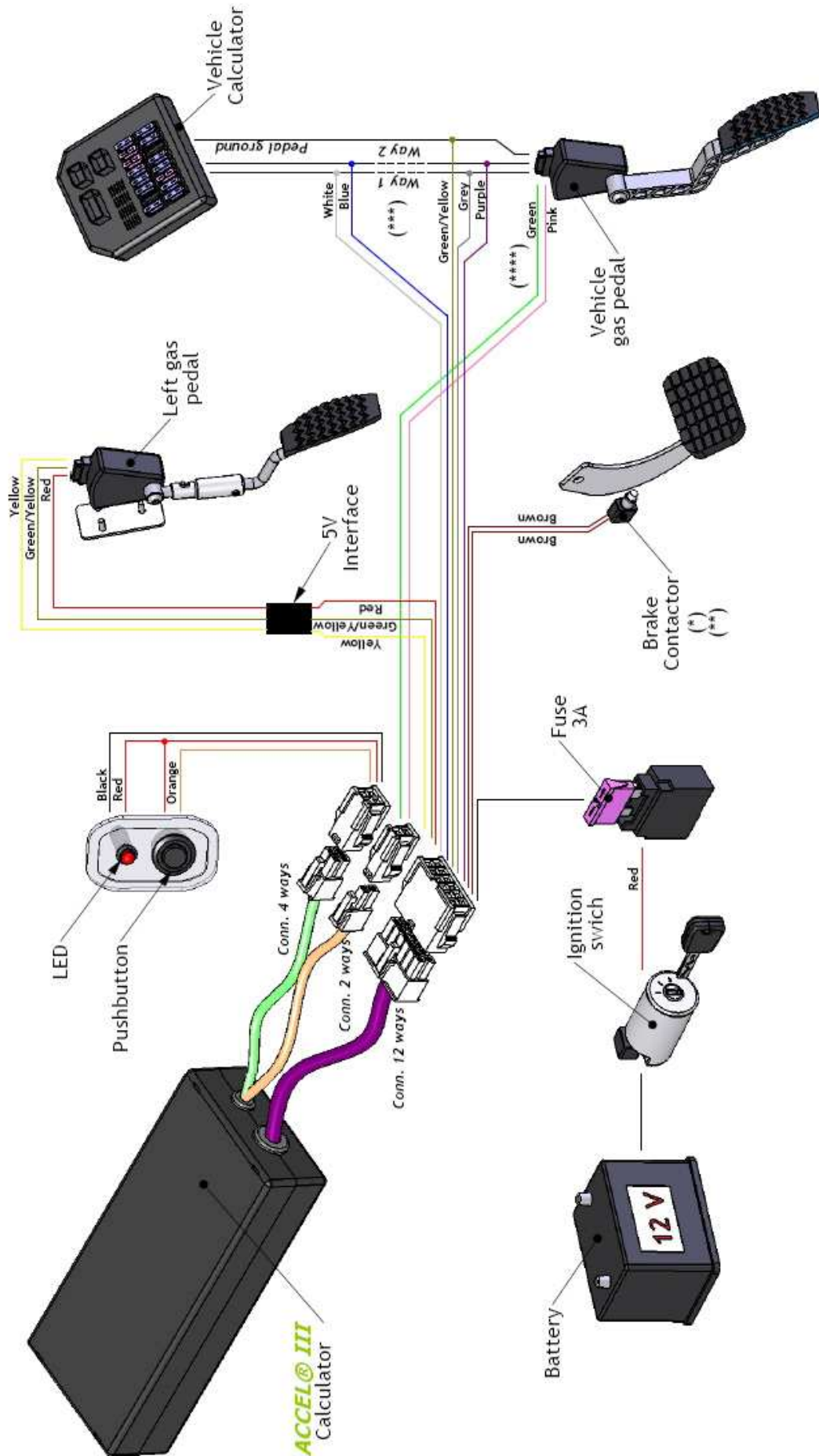

Brake contactor wiring:

Use of the contactor of origin:

If the vehicle has a normally open brake light switch and has no LED stop lights, wire the 2 brown wires on both sides of the brake light switch.

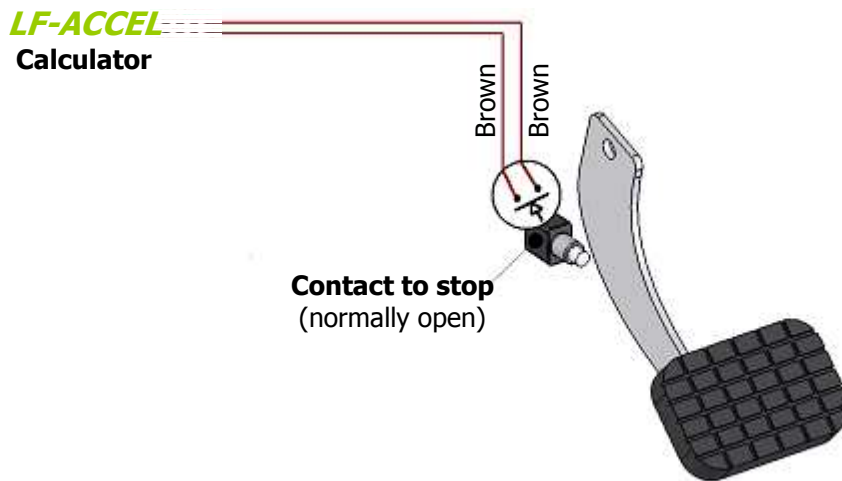

Use of another brake light switch:

If you cannot use the vehicle brake light switch of origin, put in place another contactor on the brake pedal and wire it like below:

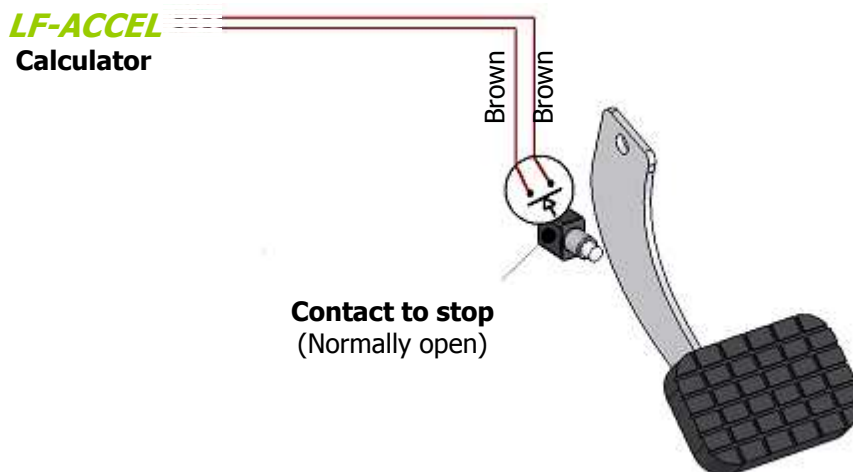

Utilisation example of Kick Down Contact to disable the speed-limiting device on PEUGEOT and CITROEN vehicles:

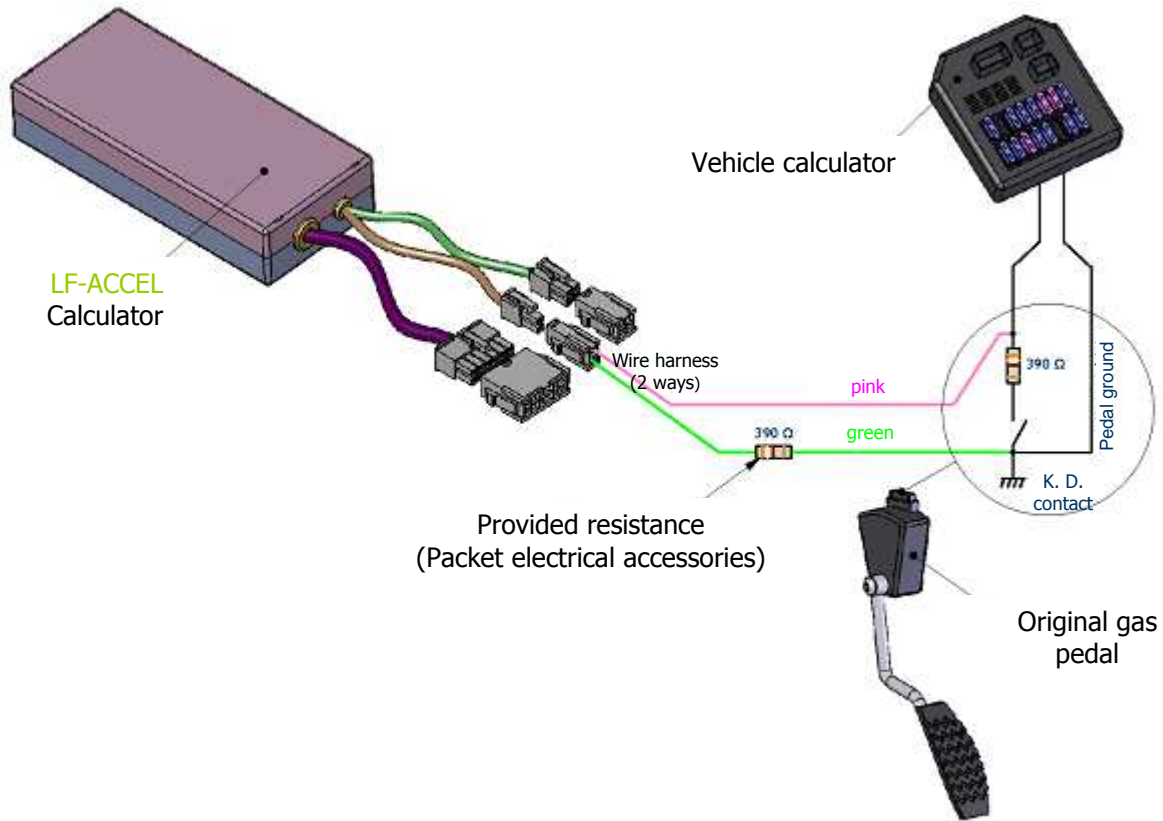

The Kick-Down contact of the car closes up at the end of pedal's acceleration stroke allowing the driver to disable the speed-limiting device if needed.

LF-ACCEL Kick-Down contact activated and with 390 Ω resistance, when wired as indicated below, makes possible to disable the speed-limiting device by pushing the commands to the maximum extend.

Tension references for **LF-ACCEL**

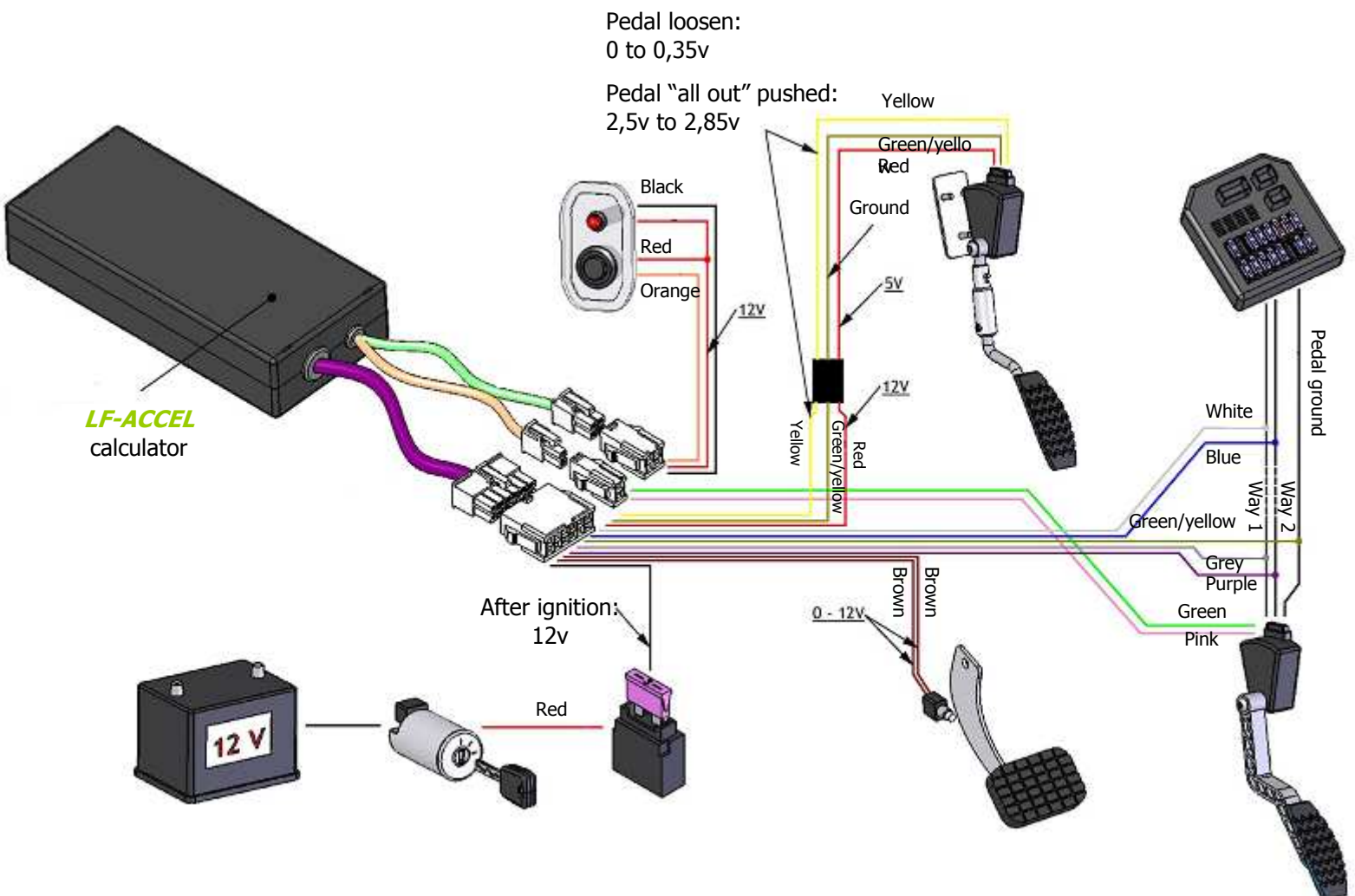

Quick diagnosis for **LF-ACCEL**

The red and green LEDs on the calculator enable quick and easy system diagnosis.



- **Switch on the system:**

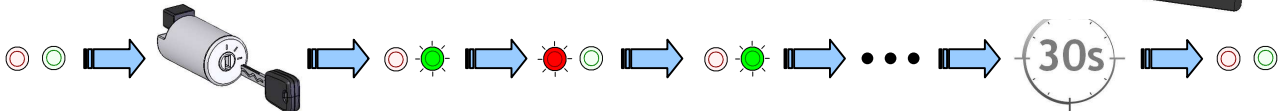

- From the car starting, the red and green LEDs are winking alternately.
- **LF-ACCEL** can be switched on (by pressure on the push button) within 30 seconds following the cars starting.

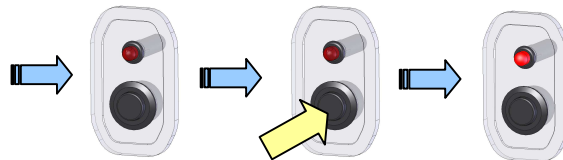

- After the activation, the red Led next to the push button is lighting
- **LF-ACCEL** is not activated within 30 seconds, switch off the car and switch on again in order to activate it.

- **LF-ACCEL** diagnosis

Function	Leds	Indicator
Contact off		
Contact on – 30 first seconds Waiting for the LF-ACCEL activation		
Contact on – after 30 first seconds LF-ACCEL activation impossible		
Brake pulled (WITH LF-ACCEL activated)		
Commands LF-ACCEL loosen (With LF-ACCEL activated – brake not activated)		
Commands LF-ACCEL pushed (With LF-ACCEL activated – brake not activated)		
Commands LF-ACCEL "all out" pushed (With LF-ACCEL activated – brake not activated)		

Left foot pedal installation

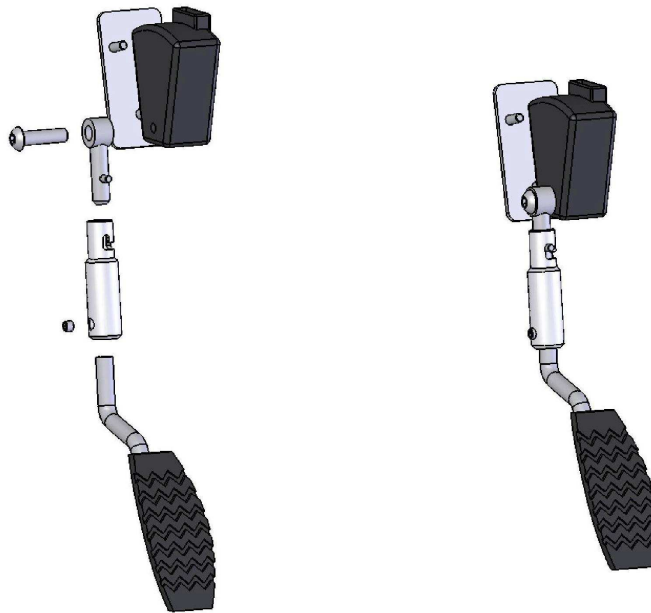

- The left foot pedal is delivered with a fixing plate, which should be positioned and fixed on the vehicle with the appropriate lugs (not supplied by *SOJADIS*).
- To enable *LF-ACCEL* to adapt on any vehicle, the left foot pedal is delivered in parts.

The installer has to shape the accelerator pedal and to fix it at the require angle (attention: once the pedal has been fixed on the cog of the electric part of the accelerator and screwed, it is difficult to remove).

- For a quick and simple removal of the left foot pedal, a quarter turn on the steal joint (ref.: APG-P1) is delivered.



List of spare parts

See diagrams next page

Marks	Reference	Designation	Quant.
1	CAL	Calculator	1
2	F2-APG	Wire harness 12 ways	1
3	F4-ACC	Wire harness 4 ways	1
4	F6-ACC	Wire harness 2 ways	1
5	1601.L7	Left foot pedal	1
	COIFFE-PEDALE	Pedal cover	1
6	APO	Fixing plate	1
7	APG-P1	Steal joint	1
8	BP-ACC	Push button and LED set	1



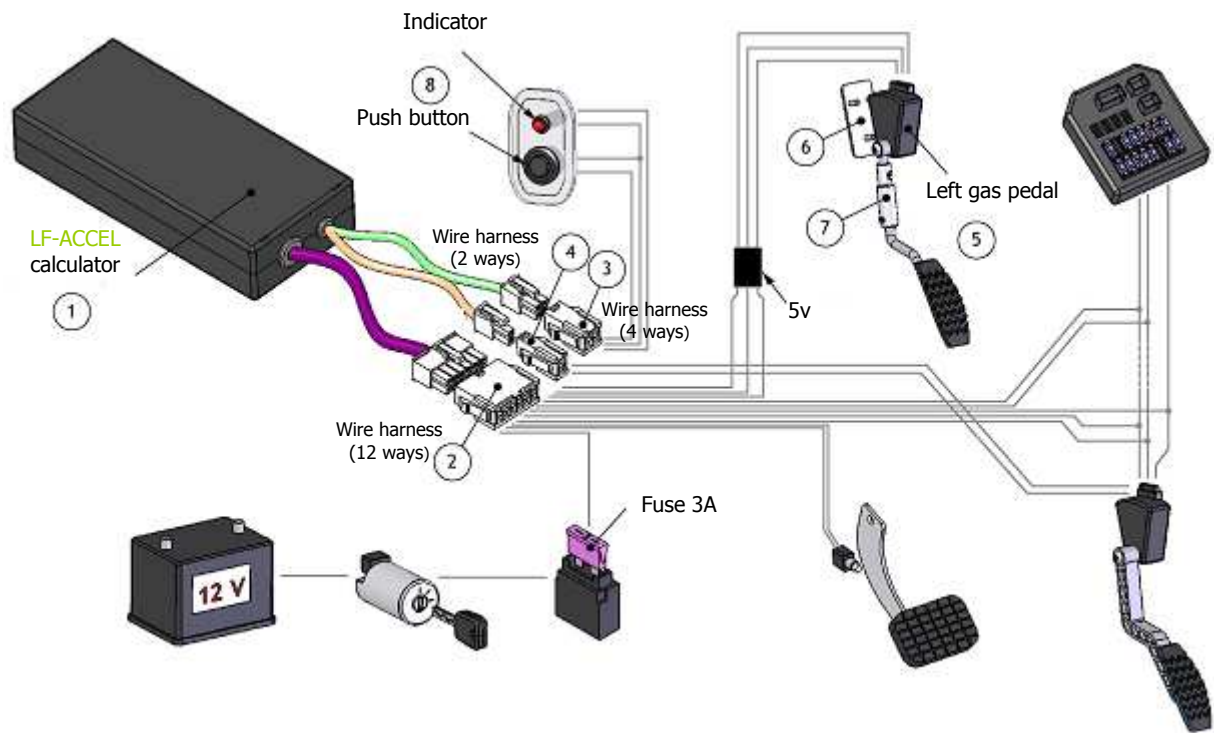

Technical characteristics

Operating temperature:

- **From - 40° to + 85°C**

Power:

- **12 V (10 - 16 V)**

In compliance with regulation 95/54/EC

Simulation of electronic information of the accelerator pedal:

- **2 analogical linear ways, increasing or decreasing parametrizable from 0 to 5 V.**
- **1 parametrizable contact closable at the beginning or at the end of pedal travel.**

⇒ **For any vehicle needing different signals, please contact *SOJADIS* or your dealer.**

Notes

