

# Universal BAS Push/Pull Fitting instructions

Photos shown of vehicle relate to a BMW 1 series and used for guidance only

## Box Contents and Description.



# Accelerator





## Brake

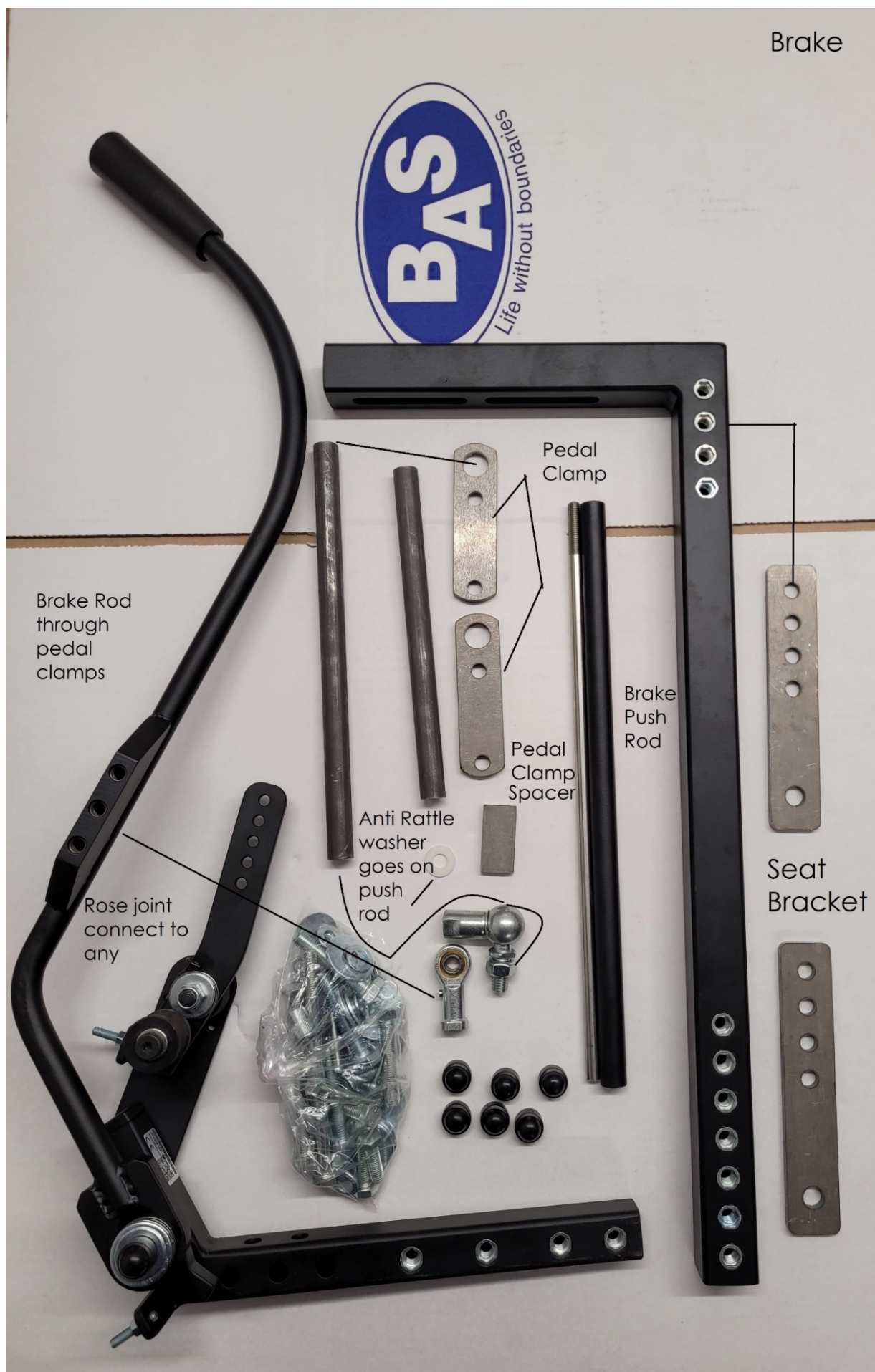



Use Spring & Flat Washers Where Needed.  
Not all bolts etc used.





- Remove O/S sill trim to assist in access to sill/Floor mounting point.



- Remove seat front mounting bolts (maybe necessary to loosen rear seat fixing bolts to enable ease of bracket fitting.)



- Slide the Adjustable lever Mounting Bracket over the Lever assembly and place in the footwell. Adjust length to find optimum position for the lever assembly.



- Fit seat brackets with original bolts between seat frame and metalwork unless otherwise stated do not fully tighten at this time.
- Loosely Fasten seat brackets to frame (these brackets may require bending or spaces adding)



- Mark sill/Floor fixing point.
- Temporary remove frame, drill as required for fixing Rivnut, or nut and bolt if access available
- Slit carpet for bolt access, if plastic trim fitted cut/drill as necessary (can use either floor mount, sill mount, or both).







- Refit carpet and side trim
- Fit bolts to secure both inner and outer frame work together. Secure body fixings, and all other frame fixings. Fully Tighten.



- Tighten seat bracket fixings and rear seat fixings if previously loosened

- Fit accelerator bracket and secure
- Secure ball joint to bracket



*Picture shown of a floor mounted accelerator pedal. For a standard pedal fasten as per brake bracket.*

- Fit and secure brake lever bracket Use grubscrews to secure internal threaded tube in bracket
- Secure ball joint to bracket





# Fitting and Measuring Accelerator & Brake Connecting Rods

## *Accelerator*

- Secure both rose and ball joint to pedal bracket and main assembly.
- Screw outer rod into rose joint along with locking nut.
- Screw inner threaded bar into the ball socket along with locking nut.
- Place free play adjuster onto rod
- Bring rod and threaded bar from both main assembly and pedal bracket together and mark where they overlap for cutting
- **Better to cut longer and trim as required (keep inner rod as long as possible) Also inner rod needs to be at its useable maximum length so does not slide out of outer tube when brake and accelerator used with original vehicle pedals.**
- Once correct length has been achieved secure all connections
- To remove any free play slide adjuster on inner rod to meet outer rod and secure



## Brake

- Secure both rose and ball joint to pedal bracket and main assembly.
- Screw outer rod into rose joint along with locking nut.
- Screw inner threaded bar into the ball socket along with locking nut.
- Bring rod and threaded bar from both main assembly and pedal bracket together and mark where they overlap for cutting
- **Better to cut longer and trim as required (keep inner rod as long as possible) Also inner rod needs to be at its useable maximum length so does not slide out of outer tube when brake and accelerator used with original vehicle pedals.**
- Once correct length has been achieved secure all connections
- To remove any free play, adjust the locking nut on outer rod





- Finished photos



- ADJUSTMENTS
- Spring adjustment
- Start position of accelerator and maximum accelerator travel.